

# Track Suspension Kit

81022



## Warning

- Note that the power needs to be isolated/switched off at the fuse board.
- **IMPORTANT:** The fixing point(s) selected must be capable of supporting the full weight of the light fitting.
- This product is suitable for indoor use only and not for areas constantly subject to moisture such as bathrooms.
- The product must be securely fixed to the mounting surface using the screws and wall plugs supplied. The screws and wall plugs supplied are suitable for "masonry" only. Other fixings not supplied and must be purchased.
- Take care not to drill into any pipes or mains cables beneath the surface during mounting holes preparation.
- Never put anything on the product or hang anything on any part of this product.
- The total height of the accessories is 300cm and the height can be adjusted.

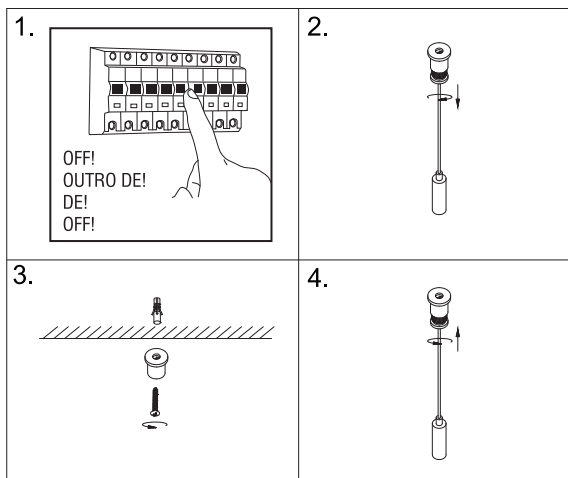
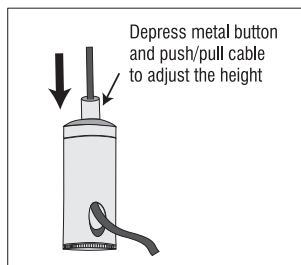

V2 19/07/2022

**UK Manufacturer:** BH17 7BY

**EU Manufacturer:** Brilliant AG,

Brilliantstrasse 1, D-27442 Gnarrenburg

[www.saxbylighting.com](http://www.saxbylighting.com)

**saxby**  
lighting