

Wiring for connecting with AltumPRO UFO highbay and Apollo Linear lowbay

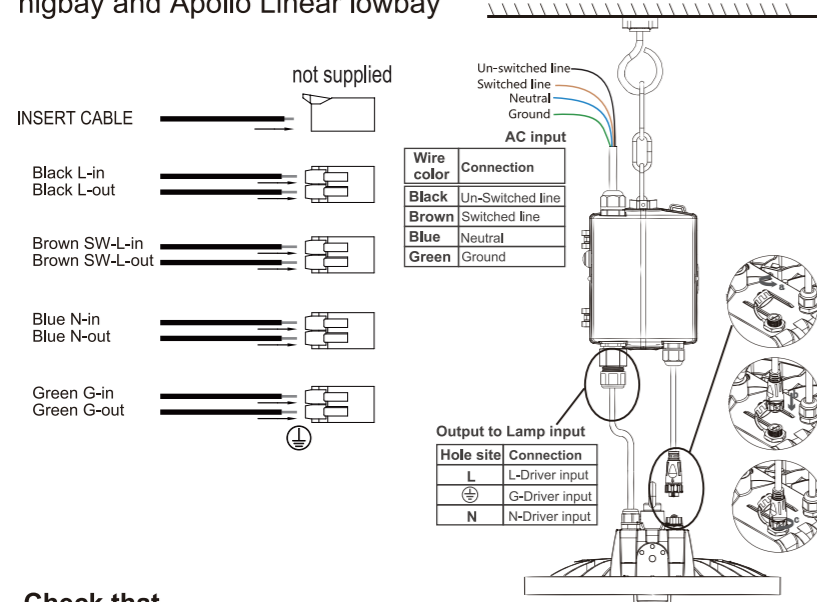

Wiring for using EM kit on its own

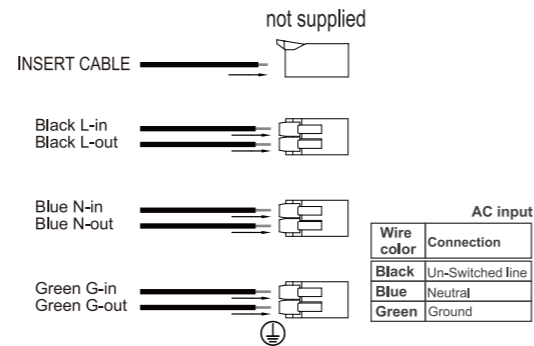

Check that...

- You have correctly identified the wires. • The connections are tight. • No loose strands have been left out of the connection block.

1. Installation and commissioning may only be carried out by authorized specialists and wired in accordance with the latest IET electrical regulations or the national standards.
2. Mains power must be switched off before carrying out installation.
3. The manufacturer shall not be liable for any damage resulting from inappropriate modifications to the luminaire or faulty installation.
4. Caution, risk of electric shock. The control gear provides basic insulation between the LV supply and the control circuit.

Instructions for Disposal (End-of-Life Management): This product contains a battery which must be disposed of separately from household waste at the end of its life. To protect the environment and human health, please ensure proper disposal of this battery and the product.

Information for Recyclers: To ensure safe and efficient recycling, the battery should be removed by trained professionals in accordance with local regulations and industry best practices for battery recycling.

We are committed to responsible sourcing of raw materials used in our products, including batteries. We adhere to robust due diligence policies to prevent and mitigate social and environmental risks throughout our supply chain, in accordance with Regulation (EU) 2023/1542.

Explanation of LED indicator

State	Color	LED indication	Status	Comment
●	Green	Permanent green	Charging Mode Fully Charged	AC mode
☀	Green	Fast flashing green (0.1 sec on, 0.1 sec off)	Function test underway	
☀	Green	Slow flashing green (1 sec on, 1 sec off)	Duration test underway	
●	Red	Permanent red	Load failure	Open circuit/ Short circuit Led failure (emergency mode)
☀	Red	Slow flashing red (1 sec on, 1 sec off)	Battery failure	Battery failed the duration test or function test / No battery
○		Green and red off	DC mode	Battery operation (emergency mode)

Care and Safety

We recommend cleaning with a soft dry cloth. Do not use solvents or abrasive cleaners as these could damage the finish. For your safety, always switch off the power supply before cleaning. Always disconnect the product from mains at least 10 minutes allowing to cool down before any maintenance or adjustment.

Instruction manual

Highbay Emergency Kit With Light Head

120809

Thank you for purchasing this product. Please read the instructions carefully before use to ensure safe and satisfactory operation of this product. Please retain these instructions for future reference.

Installation

Existing fittings must be completely removed before installation of a new product. Before removing the existing fitting, carefully note the position of each set of wires. Note that the switch is turned off before installation. Choose the Highbay Emergency Kit to install referring to the installation diagram.

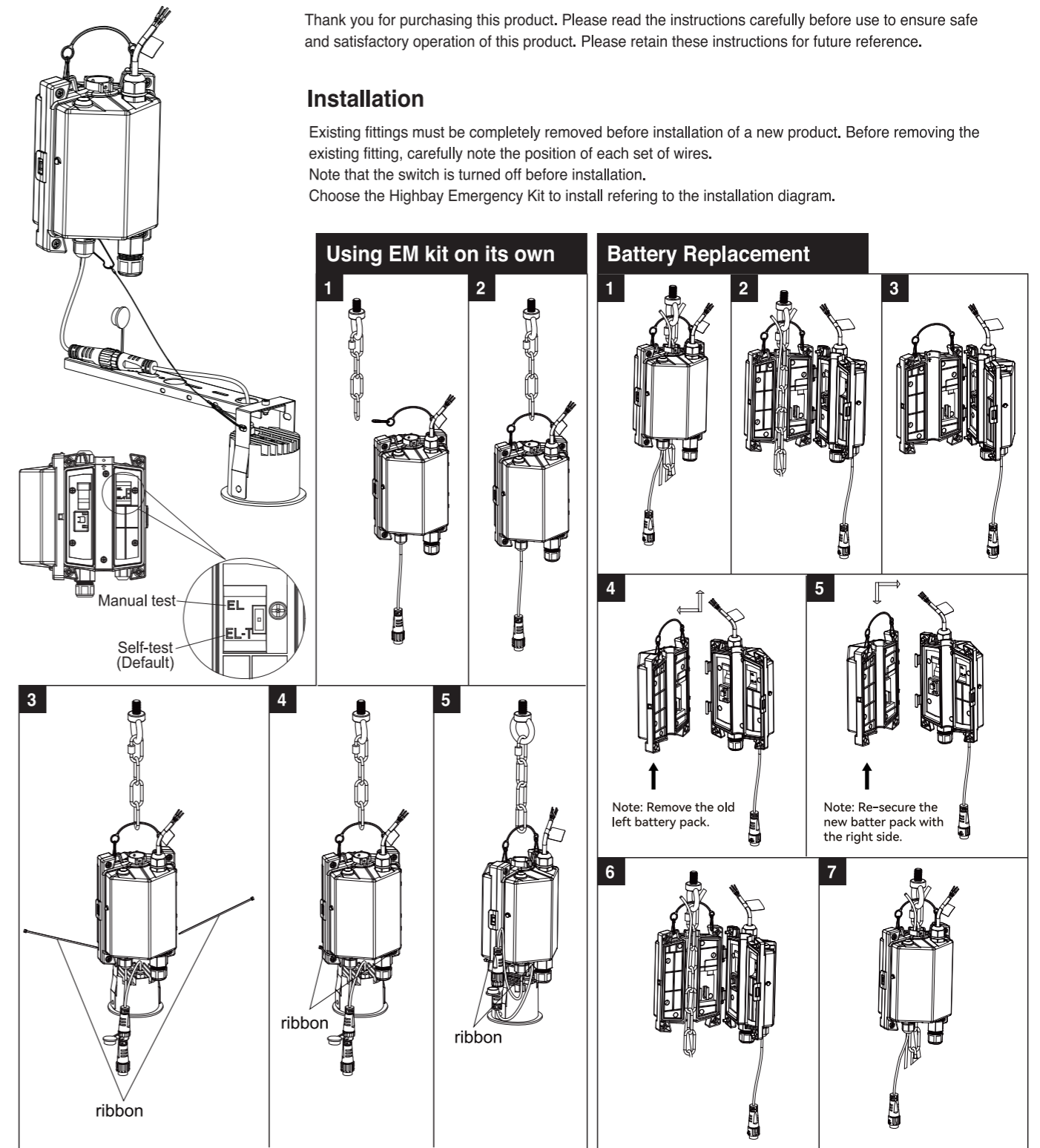

Connect with AltumPRO UFO higbay

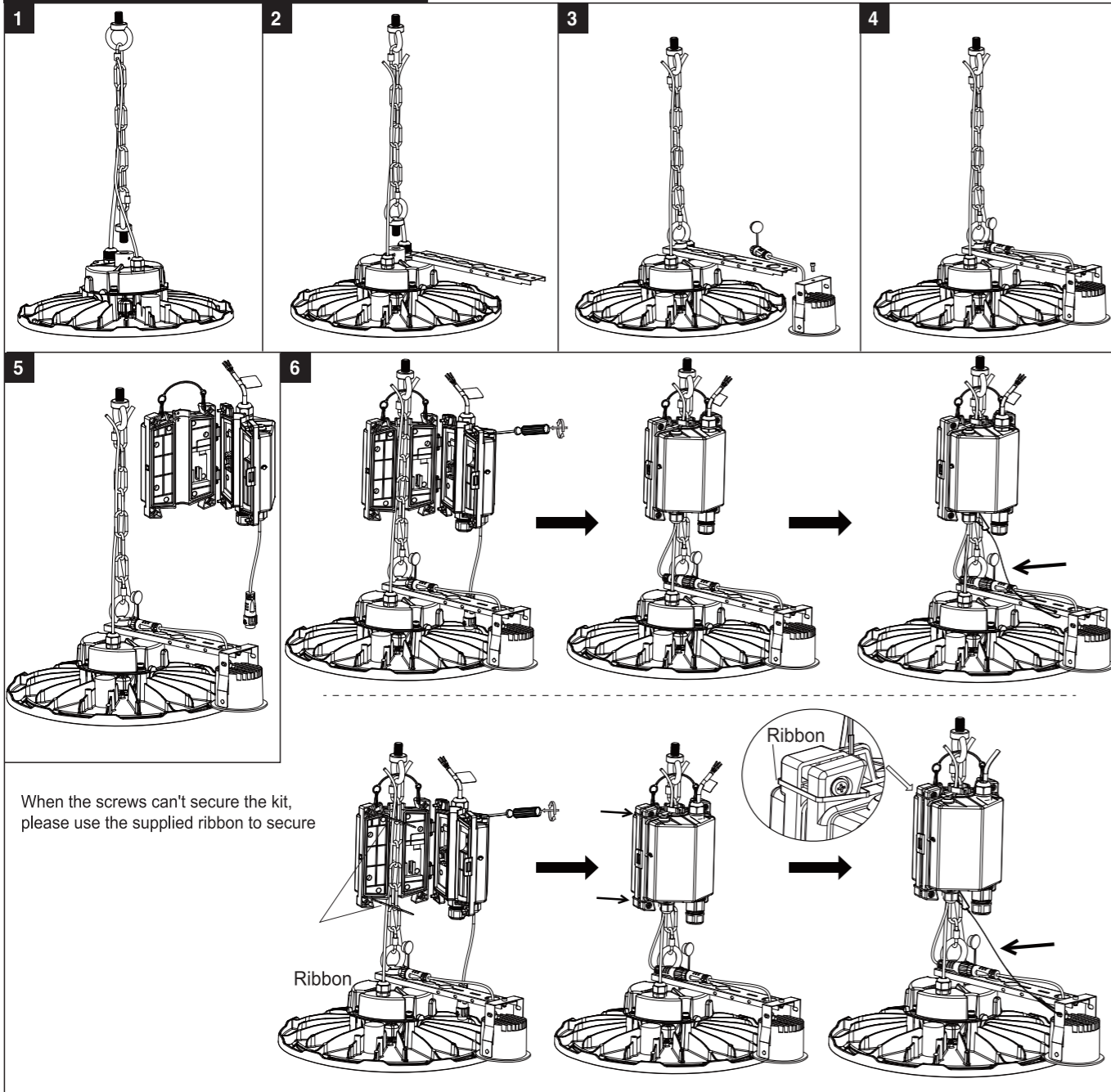

Technical data

Supply Voltage: 220-240 V~, 50 Hz

Bulb Type: 7.2W LED (COB), 4000K

This product contains a light source of energy efficiency class **G**.

CE Conformity with all relevant EC Directive requirements.

UK CA Conformity with all relevant UKCA Directive requirements.

This product is Class 1, must be connected to earth.

Waste electrical products should not be disposed of with household waste. Please recycle where facilities exist. Check with your Local Authority or local store for recycling advice.

This product is not suitable for dimming.

This product is rated at IP65.

Emergency data

Emergency mode: Non-maintained
 Emergency Output Power: 7.5W
 Emergency Output Lumen: 850lm
 Duration: 3 hours (180 minutes)
 Maximum Operating Humidity: 90%
 Change over Time: 1s
 Battery Spec: LiFePO4 6.4V 6000mAh
 Charge time: ≥24 hours
 Charge current: 0...300mA
 Output current: 160mA Max
 Battery warranty: 5 years
 Ambient Temperature: 0 °C - 40 °C

Connect with Apollo Linear lowbay

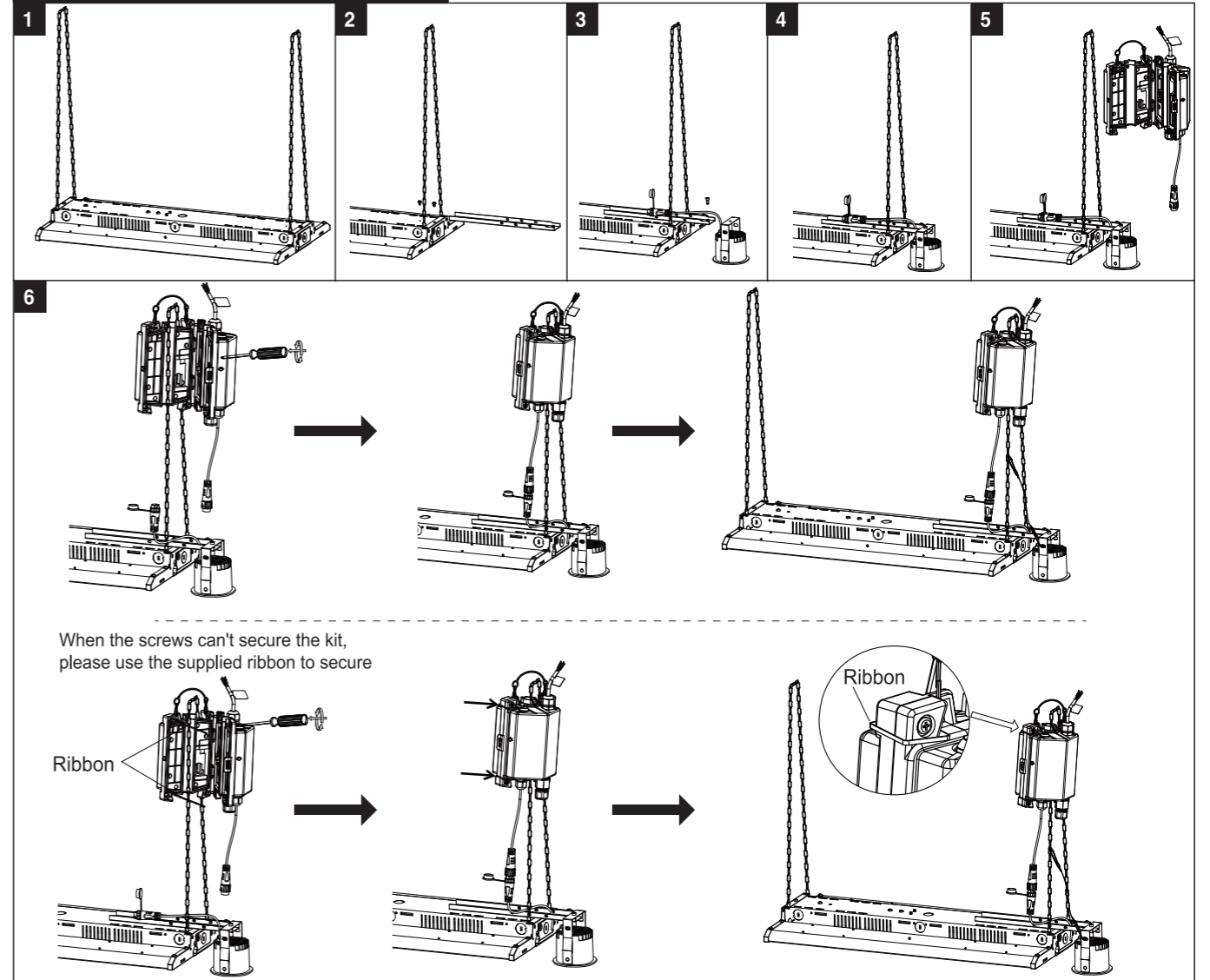

Self test

The emergency kits carry out self-tests automatically to ensure its functionality.

The self-test includes 3 types of tests:

Initial test

- As soon as mains supply is connected, the emergency kit will carry out a 3-seconds functional test automatically.
- In case of a failure, the LED will turn permanent red. Otherwise, the charge mode will start.

Functional test

- Refers to charging, discharging and the functioning of load.
- Carry out for 10 seconds automatically every 30 calendar days.

Duration test

- Refers to the test of batteries capacity.
- Carry out every 180 calendar days.

Rest mode

Rest mode can be initiated during emergency mode by pressing test switch longer than 3 seconds.

The rest mode will be exited automatically after reconnect AC mains.

Reset method(choose either of below):

1. AC power off, press and hold test button more than 5s;
2. AC power off and unplug battery, wait 5s and plug battery.

* During initial installation, the indicator light might be showing red and fitting working properly, please keep it charging for few hours, then reset, the indicator should change to green.

Dimension

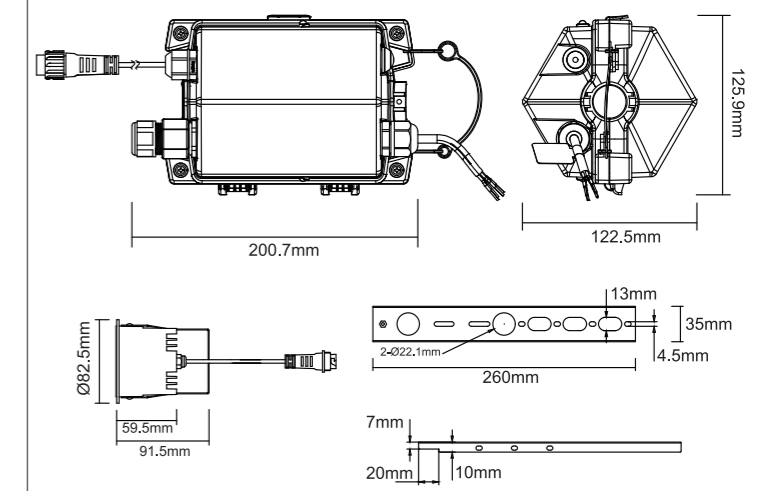

Please note

If mains supply is off during self-test period, emergency conversion module would terminate self-test immediately and go into emergency mode.
 Self-test is under the regulation of EN62034.