

Technical data

Supply Voltage: 220-240 V~, 50 Hz

Bulb Type: 18/14/9W LED (SMD) CCT, 3000/4000/6000K, 900/1400/1800Lm - 143.8Lm in EM mode
This product contains a light source of energy efficiency class **D**.



UK CA Conformity with all relevant UKCA Directive requirements.

CE Conformity with all relevant EC Directive requirements.

The power supply is Double Insulated and does not require connection to an Earth circuit.

Waste electrical products should not be disposed of with household waste. Please recycle where facilities exist. Check with your Local Authority or local store for recycling advice.

Battery parameters:	
Duration	3 hours (180 Minutes)
Maximum Operating Humidity	90%
Change over time	Approximately 1s
Battery Specification	LifePO4 3.2V 1500mAh
Battery Charge Time	24 Hours
Battery warranty	5 years
Ambient Temperature	0°C - 45°C

This product is not suitable for dimming.

This product is rated at IP65

This product is rated at IK10.

Test Function

Twist and remove the lamp cover from the product, then turn the clip to loose the LED tray in the rear casing. find the EM kit fixed in the back of LED tray.

Please note: For manual testing purposes a provision is made inside the cover of the low voltage side of the driver (Fig.1) marked as Test on the casing. See below for details on manual testing.

Turn on the power and ensure that the module is showing charge indicator.

This fitting requires a minimum 24 hours initial charge period prior to any manual emergency testing.

All full duration tests should be where possible be undertaken at times of low risk adjacent emergency luminaires we recommend that you you reset the inbuilt timer or run a manual 30 days test to stagger testing times. Once commissioned fill in the date of the first test/install date this will allow the end user to monitor and record subsequent test information on the supplied report. All tests with the exception of the visual inspection will be completed automatically including battery charge condition and lamp status.

Daily:

The product has self testing function. Visual inspection of the battery charge LED as below:

Automatic Monthly (Every 30 Days): (in addition to the daily check)The results of the short duration test shall be recorded.

Automatic Annually (Every 180 Days): (in addition to the daily check) The results of the full duration tests shall be recorded.

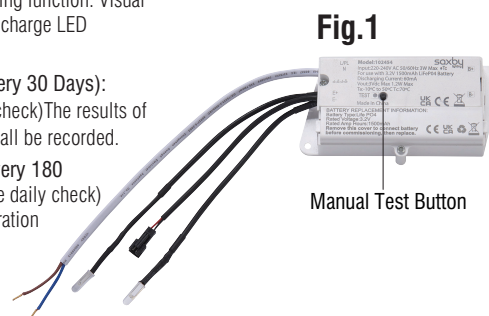

Performance Indicators:	
Normal Operation	Red LED off, Green LED Solid
Automatic 30 Days Test	Red LED off, Green LED flashing once a second
Automatic 180 Days Test	Red LED off, Green LED flashing twice a second
Manual Simulated Power Failure	Red LED off, Green LED off
Manual 30 Days Test	Red LED off, Green LED flashing once a second
Manual 180 Days Test	Red LED off, Green LED flashing twice a second
Manual Fast Test (24 minutes)	Red LED off, Green LED four times a second
Manual Testing - Can only be completed under mains conditions	
Manual Simulated Power Failure	Hold test button until you hear 1 beep
Manual 30 Days Test	Hold test button until you hear 2 beeps
Manual 180 Days Test	Hold test button until you hear 3 beeps
Manual Fast Test (24 minutes)	Hold test button until you hear 4 beeps
Abort Test	Hold the test button for 15 seconds, when you hear the long sound, the self-test function will restore the defaults
Fault Indicators:	
Battery/Charging Fault	Red LED flashing once a second, Green LED off, Beeps twice every minute until fault rectified
Lamp Fault	Red LED flashing twice a second, Green LED off, Beeps twice every minute until fault rectified
Failed Duration Test	Red LED solid, Green LED off, Beeps twice every minute until fault rectified

Care and Safety

We recommend cleaning with a soft dry cloth. Do not use solvents or abrasive cleaners as these could damage the finish.

For your safety, always switch off the power supply before cleaning.

For further information, please visit <https://www.lighting-info.co.uk/111258>

V1 01/02/2024

UK Manufacturer: BH17 7BY
EU Manufacturer: Brilliant AG,
Brilliantstrasse 1, D-27442 Gnarrenburg

saxby
lighting

Instruction manual

HeroPro CCT Self Test Emergency

111258



www.saxbylighting.com

saxby
lighting

Thank you for purchasing this light fitting. Please read the instructions carefully before use to ensure safe and satisfactory operation of this product. Please retain these instructions for future reference.

Warning

This light fitting is double insulated and does not require connection to an earth circuit.

Please read these instructions carefully before commencing any work.

This unit must be fitted by a competent and qualified electrician.

Install in accordance with the IEE Wiring regulations and current Building Regulations.

Check the pack and make sure you have all the parts listed.

To prevent electrocution switch off at the mains supply before installing or maintaining this fitting. Ensure other persons cannot restore the electrical supply without your knowledge.

If you are in any doubt, please consult a qualified electrician.

This light fitting should be connected to a circuit with a 30mA RCD fitted.

If replacing an existing fitting, make a careful note of the connections.

Waste electrical products should not be disposed of with household waste. Please recycle where facilities exist. Check with your local authority or retailer for recycling advice.

Layout

Plan the desired layout of these fittings carefully, ensuring the cables will reach the distances between each light fitting.

Avoid locating any cables in positions that would cause a hazard. Position cables and junction boxes (not supplied) away from areas where they may be at risk from being cut, trapped or damaged.

The mains supply cable must have a minimum cross section area of 1.0mm².

Cables must be protected using suitable conduit or plastic trunking.

The products can be wall or ceiling mounted. If wall mounting ensure that the power supply is at the bottom.

Installation

Existing fittings must be completely removed before installation of a new product. Before removing the existing fitting, carefully note the position of each set of wires.

Note the switch is turned off before installation.

The ceiling surface must be flat and smooth to ensure a good fit.

Ensure that the screws and cable entry points are sealed to maintain the IP rating of the product.

- Twist and remove the lamp cover from the product, keep safe for refitting later.
- Turn the clip to loose the LED tray in the rear casing.
- Using the rear casing as a template mark the position to drill out the fixing holes. Take care to avoid damaging any concealed wiring and pipes.
- Fix the rear casing into the position using the installation plugs and screws.
- Pull the cable through the cable entry hole and seal to maintain the IP rating and wire as detailed Wiring Diagram.
- Refit the LED tray back into the rear casing and lock the clip.
- Twist the lamp cover back onto the product and lock in place.
- Replace fuse or circuit breaker and switch on. Your light is now ready for use.



The wattage is changeable between the different wattage 18W/14W/9W using the wattage switch on the driver before installation.



The colour is changeable between 3000/4000/6000K using the CCT switch on the driver before installation.



Choose your preferred wattage and colour before installing by wattage switch or CCT switch on the driver. Note: Before you change the wattage or colour, please turn off the power switch for safety.

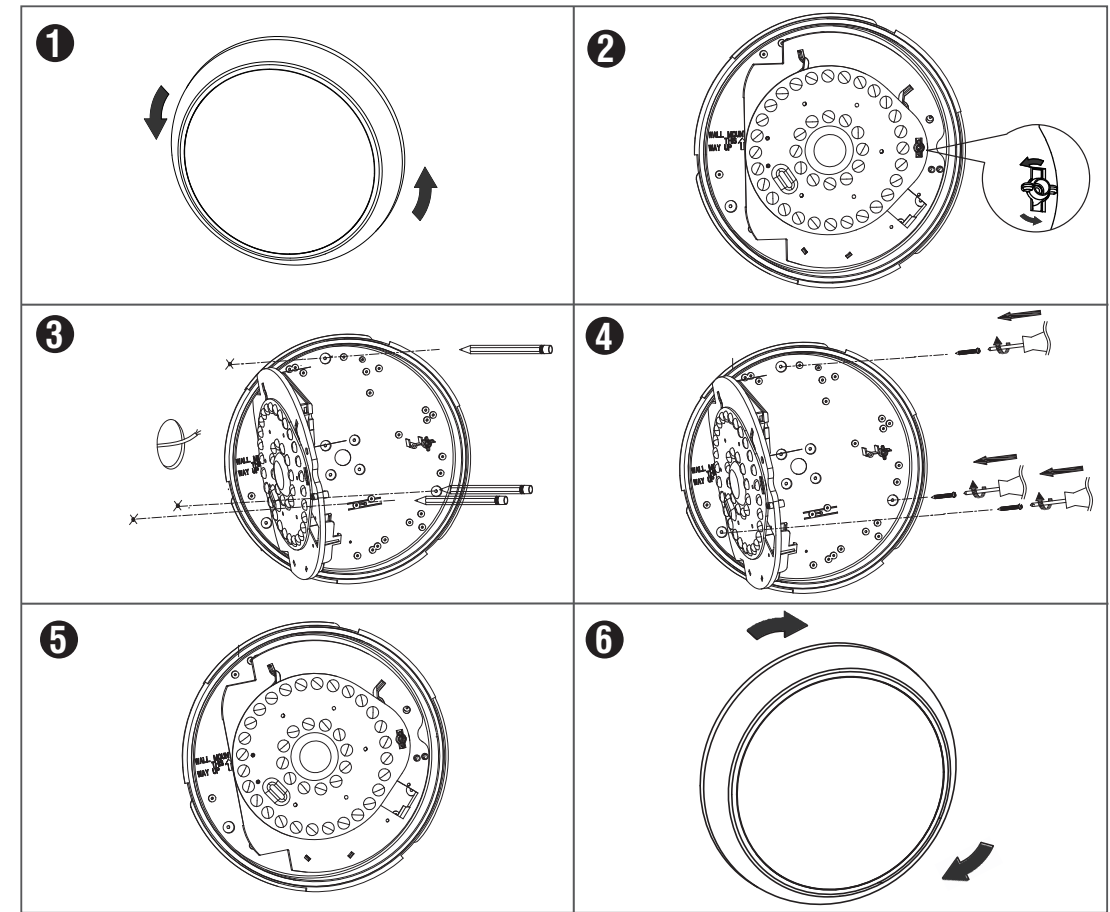

* Product images may vary.

Bezels

The following individual casings are available for purchase separately.

95545 : Chrome plain
95546 : White eyelid
95547 : White grill

95548 : Black plain
95549 : Black eyelid
95550 : Black grill

95551 : Anthracite grey plain
95552 : Anthracite grey eyelid
95553 : Anthracite grey grill

Wiring

- This product is double insulated and must not be earthed. If there are any incoming earth cables, they must be joined together and well insulated with good quality insulation tape. This is to ensure earth continuity throughout your property.
- Having correctly identified the wiring from your existing light fitting, connect to the quick fit connection block in the following way, using the supplied link cables where necessary.

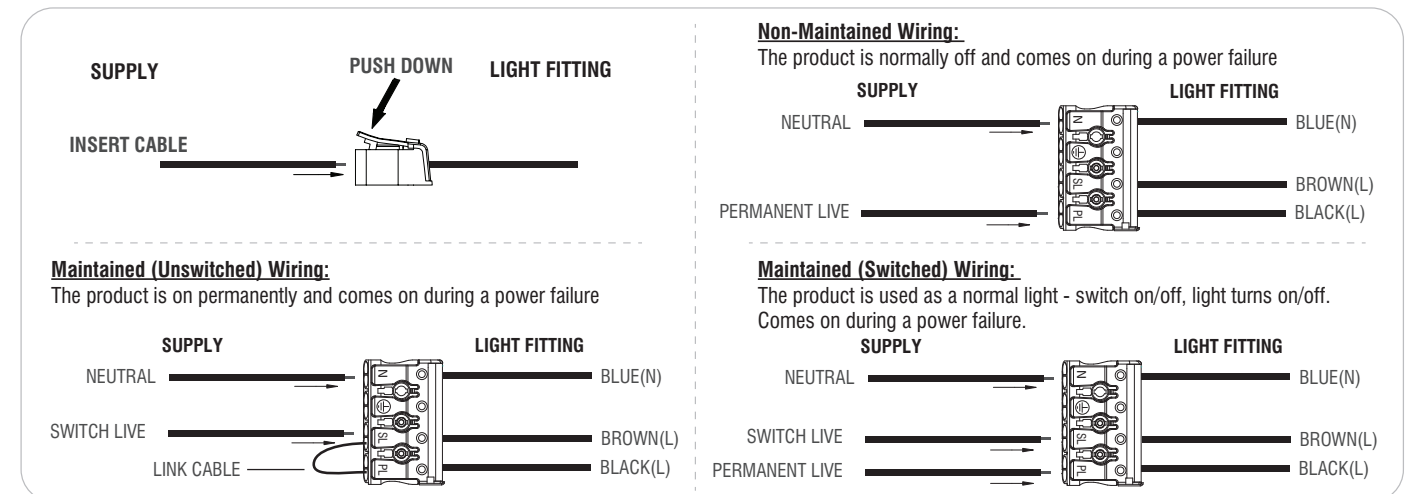

Check that...

- You have correctly identified the wires.
- The connections are tight.
- No loose strands have been left out of the connection block